

SAMS, LARKIN, HUFF & BALLI

A LIMITED LIABILITY PARTNERSHIP

GARVIS L. SAMS, JR.

JOEL L. LARKIN

PARKS F. HUFF

JAMES A. BALLI

SUITE 100

376 POWDER SPRINGS STREET

MARIETTA, GEORGIA 30064-3448

770•422•7016

TELEPHONE

770•426•6583

FACSIMILE

ADAM J. ROZEN

WWW.SLHB-LAW.COM

October 12, 2016

TO: NEARBY PROPERTY OWNERS

Re: Application of Octane Real Estate Investments, LLC to request rezoning for Property located at Tax Map 15N18, Parcel 019 B, City of Woodstock, Georgia.

Octane Real Estate Investments, LLC proposes to rezone a 4 acre tract on Main Street from DT-RO with a Historic Zone (DT-HO) to DT-RO with only the frontage on Main Street retaining the DT-HO. The request will allow the property to be developed in a manner consistent with the City of Woodstock's Future Development Map with single-family attached housing to be built by Traton Homes while maintaining the historic zone designation along the Main Street frontage. I have attached a location map for your reference.

The City of Woodstock Public Hearing process includes inviting area residents to a Public Participation Meeting to learn more about the proposal. This is an informal meeting that will allow the Applicant to tell you about the proposal. You are receiving this notice because you own property close to the proposed project. The meeting will be held on October 26, 2016 beginning at 7:00 p.m. at City of Woodstock's Magnolia Hall located at 108 Arnold Mill Road, Building C, Woodstock, Georgia 30188. Additionally, the rezoning request will be heard by the Woodstock Planning Commission on December 1, 2016 at 7:00 pm and by the Mayor and Council on December 12, 2016 at 7:00 p.m. Both of these hearings will be held at the City of Woodstock's Chambers at City Center located at 8534 Main Street, Woodstock, Georgia 30188.

If you are unable to attend the public participation meeting and would like additional information, please contact me at once either via phone or email. I look forward to seeing you at the public participation meeting.

Sincerely,

SAMS, LARKIN, HUFF & BALLI, LLP



Parks F. Huff

Attorney for the Applicant

phuff@slhb-law.com

PFH/dvm

Enclosures

cc: Traton Homes

Octane Real Estate Investments, LLC

Location Map

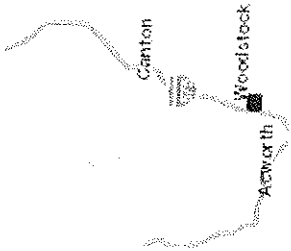
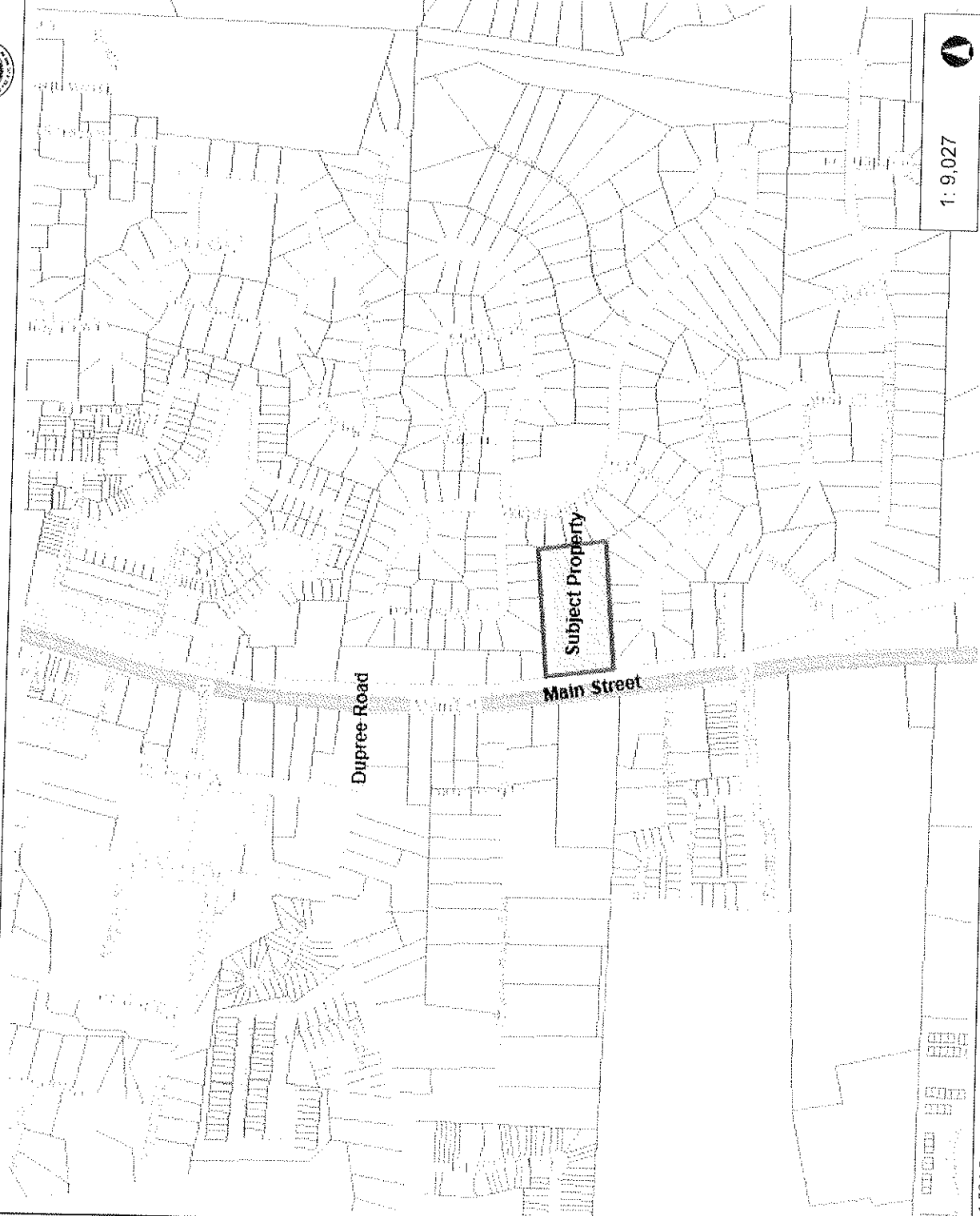

Legend

- Schools
- Churches
- Parcels

Notes

1: 9,027



This map is a user generated static output from an internet mapping site and is for reference only. Data layers that appear on this map may or may not be accurate, current, or otherwise reliable.
THIS MAP IS NOT TO BE USED FOR NAVIGATION